

Digital Video Disc Player &  
Video Cassette Recorder



**SHOWVIEW<sup>®</sup>**

*Let's make things better.*



**PHILIPS**

The region code for this set is 2.

Since it is usual for DVD movies to be released at different times in different regions of the world, all players have region codes and discs can have an optional region code. If you load a disc of a different region code to your player, you will see the region code notice on the screen. The disc will not playback, and should be unloaded.



Manufactured under license from Dolby Laboratories. "Dolby" and the double-D symbol are trademarks of Dolby Laboratories.

This product incorporates copyright protection technology that is protected by method claims of certain U.S. patents and other intellectual property rights owned by Macrovision Corporation and other rights owners. Use of this copyright protection technology must be authorised by Macrovision Corporation, and is intended for home and other limited viewing uses only unless otherwise authorised by Macrovision Corporation. Reverse engineering or disassembly is prohibited.



**The DVD/VCR is in conformity with the EMC directive and low-voltage directive.**

For Customer Use:

Read carefully the information located at the bottom of your DVD/VCR and enter below the Serial No. Retain this information for future reference.

Model No. DVD/VCR

Serial No. \_\_\_\_\_

### Laser safety

This unit employs a laser. Due to possible eye injury, only a qualified service person should remove the cover or attempt to service this device.

**USE OF CONTROLS OR ADJUSTMENTS OR PERFORMANCE OF PROCEDURES OTHER THAN THOSE SPECIFIED HEREIN MAY RESULT IN HAZARDOUS RADIATION EXPOSURE.**

### LASER

Type	Semiconductor laser GaAlAs
Wave length	655 nm (DVD) 790 nm (VCD/CD)
Output Power	0.8 mW (DVD) 0.5 mW (VCD/CD)

CLASS 1 LASER PRODUCT  
KLASSE 1 LASER PRODUKT  
KLASS 1 LASER APPARAT  
CLASSE 1 PRODUIT LASER

**(WARNING LOCATION: ON THE BACKPLATE OF SET)**

### About the PBC Function of VIDEO CD

This unit conforms to ver.1.1 and ver.2.0 of VIDEO CD standard, with PBC function.

Ver.1.1 (without PBC function): You can enjoy playback picture as well as music CD.

Ver.2.0 (with PBC function): When using a VIDEO CD with PBC function, "PBC" appears on the display.

### What is PBC? "PBC" stands for the PlayBack Control.

You can play interactive software using a menu screens. Refer to instructions of VIDEO CD.



Thank you for purchasing this Philips DVD/VCR. This Owner's Manual explains the basic operation of this DVD/VCR.

### Environmental Information

All unnecessary packaging has been omitted.

Packaging has been made easy to separate into three materials: cardboard (box), polystyrene foam (buffer) and polyethylene (bags, protective foam sheet).

Your DVD/VCR consists of materials which can be recycled and reused if disassembled by a specialised company. Please observe the local regulations regarding the disposal of packaging materials, exhausted batteries and old equipment.

### Supplied Accessories

- Remote control
- Batteries (two AA size) for remote control
- SCART cable (not available for all versions)
- Audio Cable
- RF Coaxial cable
- Owner's Manual

### Safety Information

- To reduce the risk of fire or electric shock, do not expose this device to rain or moisture.
- Before operating the DVD/VCR, check that the operating voltage indicated on the typeplate (or the voltage indication beside the voltage selector) is identical with the voltage of your local power supply. If not, please consult your dealer.
- Place the DVD/VCR on a flat, hard and stable surface.
- There must be sufficient room in front of the player for the disc tray to be opened.
- In cabinet, allow about 2.5cm (1 inch) of free space all around the player for adequate ventilation.
- Do not expose your player to extreme of temperature or humidity.
- If the DVD/VCR is brought directly from a cold to a warm location, or is placed in a very damp room, moisture may condense on the lens of the disc unit inside the DVD/VCR player. Should this occur, the DVD/VCR would not operate normally. Leave the player on for about one hour with no disc in the DVD/VCR until normal playback is possible.
- The mechanical parts of the set contain self-lubricating bearings and must not be oiled or lubricated.
- Never spill liquid of any kind on this unit. If liquid is spilled into the unit, consult qualified service engineer.
- **When the DVD/VCR is switched to Standby mode, it is still consuming some power. To disconnect the system from the power supply completely, remove the AC power plug from the wall socket.**

### Symbols Used in this Manual

The below symbols appear in some headings and notes with the following meanings:

	- Description refers to playback of DVD-video discs
	- Description refers to playback of Audio CDs
	- Description refers to playback of MP3 files
	- Description refers to playback of video CDs.

### Helpful Hints!

- Some DVD video discs require specific functions or allow only limited functions during playback.
- "☒" may appears on the TV screen which means that the function is not available on that specific DVD video disc.

---

<b>Introduction</b>	
Environmental Information	2
Supplied Accessories	2
Safety Information	2
Symbols Used in this Manual	2

---

<b>Functional Overview</b>	
Front Panel	4
Rear Panel	4
Remote Control	5

---

<b>Setting Up your DVD/VCR</b>	
Basic Connections	6
Connecting to a TV	6
Simplest connection using only supplied black RF coaxial cable	6
Connecting to an Audio System(for DVD features)	6
Connecting to Optional Equipment (for DVD features)	6
External Input Mode (for VCR features)	7
Inserting batteries into the Remote Control	7
Using the Remote Control	7
Playable Video Cassette Tapes	7
Turning on your DVD/VCR	7
Video Channel Setting	7
Automatic Channel Setup	8
Manual Channel Preset	8
Follow TV (Automatic TV channels sorting)	8
Sorting and clearing TV channels manually	8
Setting the language	8
Setting the clock	9
Setting the RF out channel	9
Decoder allocation	9

---

<b>VCR Playback</b>	
Playing cassettes	10
Playing back NTSC cassettes	10
Displaying current tape position	10
Searching for a tape position with picture (scanning)	10
Still picture / slow motion	10
Searching for tape position without picture (forward wind and rewind)	10
Index search	10
Manual Tracking	10

---

<b>VCR Manual Recording</b>	
General information	10
Recording without automatic switch-off	10
Lining up recordings (assemble cut)	11
Selecting the recording speed (SP or LP)	11
Automatic controlled recording from a satellite receiver (RECORD LINK)	11
'Direct Record'	11
Switching 'Direct Record' on or off	11
Direct dubbing	11
Recording (From DVD To VCR)	11

---

<b>Programming a Recording (TIMER)</b>	
General information	12
Programming a recording (with the 'SHOWVIEW® system')	12
Programming a recording (without the SHOWVIEW system)	12
OTR (One Touch Recording)	12
How to check, or delete a programmed recording (TIMER)	13
How to change a programmed recording (TIMER)	13
Hints for Timer Recording	13

---

<b>Other Functions</b>	
Switching the status display off or on	13
Blue Background on or off	13
Clock Display	13
Selecting the sound channel	13

---

<b>Playing a Disc</b>	
Basic Playback	14
General Features	14
Pause	14
Disc Menus	14
Title Menu	14
Calling Up a Menu During Playback	14
Step by Step Playback	14
Resume	14
Fast Forward / Reverse Search	14
Slow Forward / Slow Reverse	14
Zoom	15
Track	15
Title / Chapter Search	15
Time Search	15
Repeat	15
Program	16
Random Playback	16
MP3/JPEG Playback	16
On-Screen Information	16
Track Selection	16
Random Playback	16
Program	16
Audio Language	16
Stereo Sound Mode	16
Subtitle Language	17
Camera Angle	17
Changing the On-Screen Display	17
Parental Control	17
Marker Setup Screen	17

---

<b>DVD Setup</b>	
Audio Setting	18
Virtual Surround	18
Language Setting	18
Display Setting	18

---

<b>Information</b>	
Maintenance	18
Specifications	19
Troubleshooting	19

# SHOWVIEW®

SHOWVIEW is a registered trademark of Gemstar Development Corporation.

The SHOWVIEW system is manufactured under licence from Gemstar Development Corporation.

# Functional Overview

English

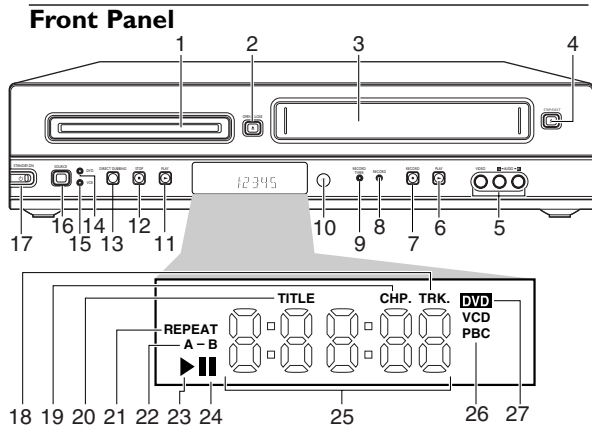

1. **Disc Tray (DVD)**  
insert a disc here
2. **▲ OPEN/CLOSE button (DVD)**  
to open/close the disc tray
3. **Cassette Compartment (VCR)**  
insert a tape here
4. **▲ STOP/EJECT button (VCR)**  
when playback is stopped, press to eject the tape
5. **AUDIO and VIDEO in jacks**  
connect to AUDIO and VIDEO OUT of an audio source
6. **▶ PLAY button (VCR)**  
to play a tape
7. **RECORD button (VCR)**  
Press once to start recording, repeatedly to start an One-Touch Recording
8. **RECORD light (VCR)**  
light appears during recording, it flashes when a recording is paused
9. **RECORD TIMER light (VCR)**  
light appears when DVD/VCR is in standby mode for a timer recording (also light appears during timer recording)
10. **IR (Infrared) Remote Sensor (DVD,VCR)**  
receive signals from remote control
11. **▶ PLAY button (DVD)**  
to start, pause or resume disc playback
12. **■ STOP button (DVD)**  
to stop playback
13. **DIRECT DUBBING button (VCR)**  
to play DVD disc and record its' content to video cassette tape at the same time
14. **DVD light (DVD)**  
light appears when DVD/VCR in DVD mode

15. **VCR light (VCR)**  
light appears when DVD/VCR in VCR mode
16. **SOURCE button (DVD,VCR)**  
to select between DVD and VCR mode
17. **○ STANDBY-ON button (DVD,VCR)**  
to switch the player to ON or OFF  
**STANDBY-ON light (DVD,VCR)**  
light appears when DVD/VCR turns on.
18. **TRK (DVD)**  
Stays on when repeat track function is on.
19. **CHP. (DVD)**  
Stays on when repeat chapter function is on.
20. **TITLE (DVD)**  
Stays on when repeat title function is on.
21. **REPEAT (DVD)**  
Stays on when the repeat function is on.
22. **A-B REPEAT (DVD)**  
Stays on when the A-B repeat function is on.
23. **▶ (DVD,VCR)**  
Stays on when the inserted disc or cassette is being played back.
24. **|| (DVD,VCR)**  
Lights up when the inserted disc comes to a pause.(DVD)  
Lights up when the playback is in a still or in a slow mode.(VCR)
25. **Digital Display (DVD,VCR)**  
Displays how long a current title or track has been played back. When a chapter or track has switched, the number of a new title, chapter or track is displayed.(DVD)  
Works as a clock, or a tape counter. Also displays a channel number, and remaining time for OTR.(VCR)
26. **CD**  
Lights up when a CD is inserted on the tray.  
**VCD**  
Lights up when a VCD is inserted on the tray.  
**PBC**  
Lights up when a VCD(with PBC function) is inserted on the tray.
27. **DVD**  
Lights up when a DVD is inserted on the tray.

## Display Message

----	Appears after the disc tray closes if the tray is empty, if there is an error reading the disc, or if an unacceptable disc is installed.
OPEN	Tray is opening or is open.
CLOSE	Tray is closing. This also may appear as the Player tries to load a Disc.
Load	Disc is loading.

## Rear Panel

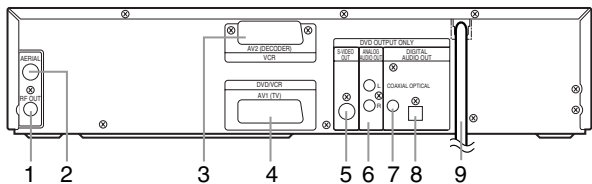

1. **RF OUT jack**  
use supplied RF coaxial cable to connect to the ANTENNA IN on your TV, cable box or Direct Broadcast System
2. **AERIAL jack**  
connect to an antenna or cable
3. **AV2 (DECODER) jack (VCR only)**  
connect SCART cable from another DVD/VCR, camcorder or an audio/video source

4. **AV1 (TV) jack**  
connect SCART cable to a TV
5. **S-Video Out jack (DVD only)**  
connect to a TV with S-Video inputs
6. **AUDIO OUT (Left/Right) jacks (DVD only)**  
connect to AUDIO inputs of an amplifier, receiver or stereo system
7. **COAXIAL (Digital audio out) jack (DVD only)**  
connect to AUDIO inputs of a digital (coaxial) audio equipment
8. **OPTICAL (Digital audio out) jack (DVD only)**  
connect to digital (optical) audio equipment
9. **MAINS (AC Power Cord)**  
connect to a standard AC outlet

## Remote Control

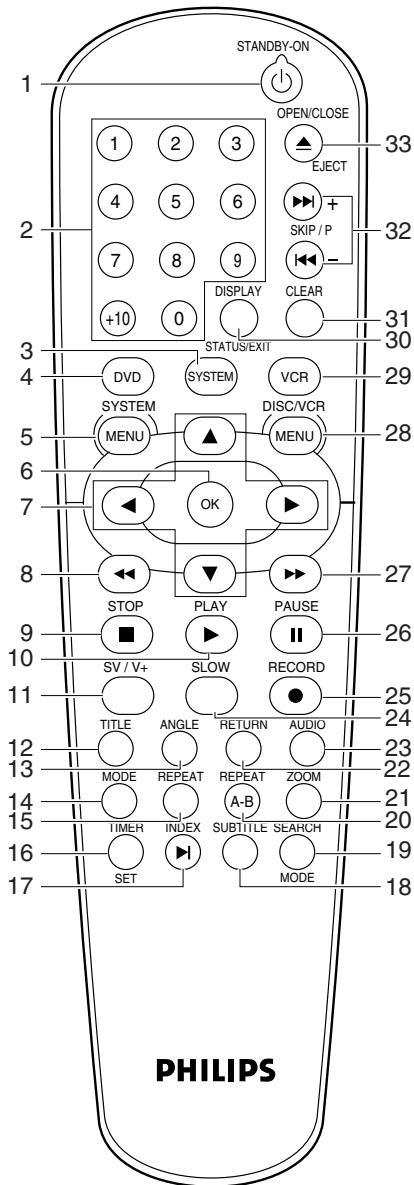

1. **⏻ STANDBY-ON**  
switch DVD/VCR ON or OFF
2. **0-9 numerical key pad/+10**  
select numbered items in a menu  
use +10 button to enter number 10 and above (DVD)  
to select TV channels in VCR mode
3. **SYSTEM**  
doesn't work on this model
4. **DVD**  
press to put the DVD/VCR in DVD mode and before using the remote control for DVD features
5. **SYSTEM MENU**  
to access or remove the DVD setup menu (DVD)
6. **OK**  
acknowledge menu selection (DVD)
7. **◀▶▶▲▼**  
(left/right/up/down) select an item in the menu

8. **◀◀**  
to view DVD picture in fast reverse motion (DVD)  
to rewind the tape (VCR)
9. **STOP (■)**  
to stop a DVD disc playback (DVD)  
to stop playback, recording(VCR)
10. **PLAY (▶)**  
to start a DVD disc playback (DVD)  
to start a tape playback(VCR)
11. **SV/V+**  
to programme timer recording with the SHOWVIEW system (VCR)
12. **TITLE**  
to display title menu of a disc (DVD)
13. **ANGLE**  
select DVD camera angle (DVD)
14. **MODE**  
to set up programmed or random playback (Audio CD)
15. **REPEAT**  
repeat chapter, track, title, disc (DVD)
16. **TIMER SET**  
to put the DVD/VCR into standby mode for a timer recording
17. **INDEX SEARCH**  
to fast forward or rewind the tape at index number (VCR)
18. **SUBTITLE**  
subtitle language DVD selector (DVD)
19. **SEARCH MODE**  
to access or remove search display (DVD)
20. **REPEAT (A-B)**  
repeat a specific segment (DVD)
21. **ZOOM**  
enlarge DVD video image (DVD)
22. **RETURN**  
to return previous or remove setup menu (DVD)
23. **AUDIO**  
to choose audio languages or sound modes (DVD)  
to choose sound modes (VCR)
24. **SLOW**  
to view tape playback in slow motion (VCR)
25. **RECORD**  
to record the TV channel selected at this moment or press repeatedly to start a One-Touch Recording (VCR)
26. **PAUSE (||)**  
pause playback temporarily / frame-by-frame playback (DVD)  
pause playback and during recording temporarily (VCR)
27. **▶▶**  
to view DVD picture in fast forward motion (DVD)  
to fast forward the tape (VCR)
28. **DISC/VCR MENU**  
to display the menu of the DVD disc or to access VCR menu
29. **VCR**  
press to put the DVD/VCR in VCR mode and before using the remote control for VCR features
30. **DISPLAY STATUS/EXIT**  
to access or remove the display screen during DVD or Audio CD playback(DVD)  
to access or remove VCR's on-screen status display(VCR)  
to remove VCR's menu(VCR)
31. **CLEAR**  
to reset the setting (DVD)  
to reset the counter (VCR)  
to delete last entry/Clear programmed recording (TIMER) (VCR)
32. **SKIP/P (◀◀|/ -|▶▶| +)**  
to skip chapter/tracks (DVD)  
to change TV channels (VCR)
33. **OPEN/CLOSE EJECT**  
to insert discs into or remove them from the tray (DVD)  
to remove the tape from the VCR (VCR)

# Setting Up your DVD/VCR

## Basic Connections

- Please refer to the instruction books of your TV, VCR, Stereo System or other devices as necessary to make the best connections.
  - Make one of the following connections, depending on the capabilities of your existing equipment.
- The following guidelines are options for the best picture and sound quality available on your DVD/VCR.

### Picture

- 1 Use SCART RGB Output (DVD/VCR(AV1 TV)) for best picture quality (for DVD features).
- 2 Use S-VIDEO Output for the better picture quality (for DVD features only).
- 3 Use SCART Composite Output for good picture quality (for DVD and VCR features).
- 4 If your TV only has a RF-style (Antenna IN or 75 ohm) input, use the RF OUT for connection and set your TV to channel 22 ~ 69 with the same channel for DVD/VCR is set (for DVD and VCR features).

### Sound

- 1 Digital audio connections provide the clearest sound. Connect the DVD/VCR DIGITAL AUDIO OUT (either COAXIAL or OPTICAL) to your amplifier or receiver (for DVD features only).
  - 2 Use SCART Output (DVD/VCR(AV1 TV)) for better sound quality (for DVD and VCR features).
- If digital connections are not possible, connect the DVD/VCR ANALOG AUDIO OUT (Left and Right) to your amplifier, receiver, stereo or TV (for DVD features only).

### Warning!

- **Never make or change connections with the power switched on.**
- **Connect the DVD/VCR directly to your TV, instead of eg. a VCR, to avoid distortion because DVD video discs are copy protected.**
- **Do not connect the ANALOG AUDIO OUT of DVD/VCR to PHONO IN of your amplifier or receiver.**
- **If you use the Euro audio/video cable, it is not necessary to connect the analog audio cable.**

## Connecting to a TV

- 1 Connect the antenna or cable to the AERIAL of your DVD/VCR.
- 2 Connect the DVD/VCR (AV1 TV) on the DVD/VCR to the corresponding connector on the TV.

### Note:

- **Ensure that the "TV" indication on SCART cable is connected to the TV set and "DVD" indication on SCART cable is connected to the DVD/VCR.**

If your TV is not equipped with a SCART input, you can select the following connection:

### If your TV has a S-Video input connector,

- 1 Connect the antenna or cable to the AERIAL of your DVD/VCR.
- 2 Connect the S-Video out on the DVD/VCR to the S-Video in on the TV.
- 3 Connect the ANALOG AUDIO OUT on the DVD/VCR to the Left and Right audio in on the TV.

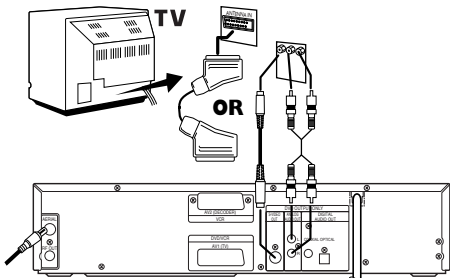

### Note:

- **You will still need the SCART cable or RF coaxial cable for VCR features.**

## Simplest connection using only supplied black RF coaxial cable

- 1 Disconnect the antenna or cable from your TV.
- 2 Connect the antenna or cable to the AERIAL of your DVD/VCR.
- 3 Connect black RF coaxial cable to the RF OUT on the rear panel of the DVD/VCR and to the ANTENNA IN on the TV.
- 4 Plug in the power cords of the TV and DVD/VCR.

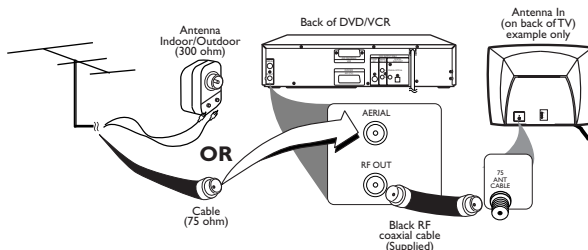

## Connecting to an Audio System (for DVD features)

- 1 You can also listen to the sound of audio CDs and DVD video discs by connecting to an optional stereo system.
- 2 Connect DVD/VCR ANALOG AUDIO OUT (Left and Right) to the audio in on the stereo system.

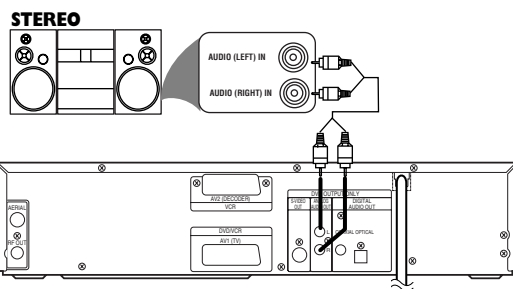

## Connecting to Optional Equipment (for DVD features)

- A digital component with a built-in MPEG 2 or Dolby Digital™ decoder allows you to enjoy the surround sound while producing the effect of being in a movie theater or a concert hall.
- The player outputs the surround sound signals from the DIGITAL OUT COAXIAL or OPTICAL connector.

- If your receiver has a MPEG 2 or Dolby Digital™ decoder,**
- 1 Connect the COAXIAL or OPTICAL DIGITAL AUDIO OUT of the DVD/VCR to the COAXIAL or OPTICAL DIGITAL AUDIO IN on your receiver.

### Note:

- **If the audio format of the digital output does not match the capabilities of your receiver, the receiver will produce a strong, distorted sound or no sound at all.**
- **MP3 Audio is not available on the Digital Output.**
- **You will still need the video cable or RF coaxial cable for VCR features.**

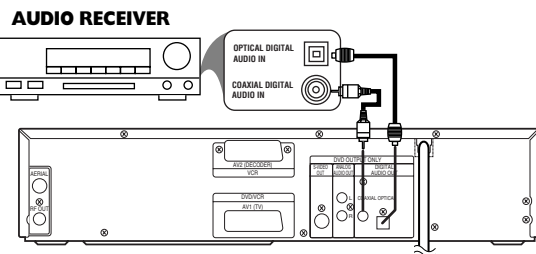

## External Input Mode (for VCR features)

To receive the signal from an external input (decoder, satellite receiver, video camera, another VCR etc.), connect to the AV2 (DECODER) socket, and enter "002" with numerical key pads button to appear "AV2" on the TV screen.  
 If you use the AV1 (TV) socket, enter "001" with numerical key pads to appear "AV1" on the TV screen.  
 If you use the front AUDIO/VIDEO input jacks, enter "003" with numerical key pads to appear "AV3" on the TV screen.

## Inserting batteries into the Remote Control

- 1 Open the battery cover.
- 2 Insert batteries (AA size) with the correct polarity as indicated by the + and - symbols inside the battery compartment.
- 3 Close the cover.

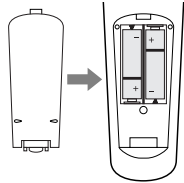

### CAUTION!

- Remove batteries if they are exhausted or not to be used for a long time.
- Do not use old and new or different types of batteries in combination.
- Batteries contain chemical substances, so they should be disposed off properly and kept away from children.

## Using the Remote Control

- Direct the remote control at the remote sensor of the DVD/VCR.
- Do not drop the remote control.
- Do not leave the remote control near extremely hot or humid place.
- Do not spill water or put anything wet on the remote control.

## Playable Video Cassette Tapes

Philips Consume Electronics recommends that only video cassette tapes that have the VHS mark and High Quality (HQ) system is compatible with this DVD/VCR. This DVD/VCR has an Automatic Head Cleaner.

### Recording Prevention

Video cassette tapes have record tabs to ensure recordings are not erased accidentally.

- 1 To prevent recording, break off the tab with a screw-driver.
- 2 To allow recording, cover the hole with cellophane tape.

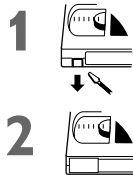

### Notes:

- Use only tapes with VHS mark.
- Remove any adhesive stick-on notes from the tape before inserting into the DVD/VCR.
- Periodic maintenance is required to maintain your DVD/VCR performance.
- Video heads will require replacement after a period of time. Only an authorised service center should perform this service.

## Turning on your DVD/VCR

The following steps only be performed when you insert the AC PLUG at the first time.

- 1 Turn on the TV and select the video channel on the TV.
- 2 Plug in the DVD/VCR.
- 3 Press ▲/▼ repeatedly to select your desired language.
- 4 Press DISC/VCR MENU.
- 5 Confirm with P+.  
The automatic TV channel search starts.
- 6 'TIME' and 'DATE' will appear on the TV screen.
- 7 Check 'TIME'. If required, please change the time with numerical key pads.
- 8 Check if the displayed settings for 'DAY', 'MONTH' and 'YEAR' are correct.
- 9 When all information is correct, save by pressing STATUS/EXIT. The preparation for use is now complete.

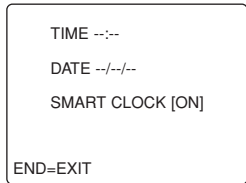
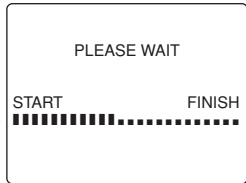
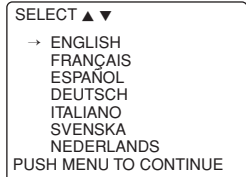

### Notes:

- If the DVD/VCR has been completed AUTO TUNING at this procedure, this initial menu has never shown even if power failure is occurred or inserted AC plug again.)

## Video Channel Setting

Video channel setting will be necessary, if your DVD/VCR is connected to the TV via the coaxial cable.

- 1 Insert a pre-recorded tape into the DVD/VCR. The DVD/VCR will turn on and start playback automatically.  
If playback does not start, press PLAY ►.
- 2 Select and adjust your TV to channel 36.
  - If the playback picture appears on the TV screen, continue with step 8.
  - If channel 36 is employed for broadcasting, or interference lines appear on the picture, the RF converter must be set to a different channel between CH22 and CH69. Continue with step 3.
- 3 Press DISC/VCR MENU.
- 4 Press ▲/▼ to select INITIAL SET UP. Then, press ►.
- 5 Press ▲/▼ to select RF OUT. Then, press ► twice.
- 6 Press ▲/▼ to select a channel which is not used for broadcasted between channel 22 and channel 69 in your area, then press ►.
  - You can also see the selecting RF channel in the display
- 7 Press STATUS/EXIT to exit.  
Set the TV channel to the RF OUT CHANNEL which was selected on the DVD/VCR. A picture from the VCR will appear on the TV screen. If a picture does not appear, repeat steps 3 to 7 using a different channel which is not used for broadcasted.
- 8 Press STOP ■ to stop the tape.

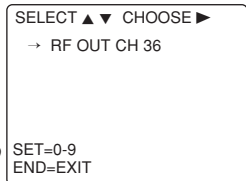

### Note:

- You may also access the RF OUT CH menu by pressing and holding DISC/VCR MENU for 3 seconds during power off until the RF OUT CH menu appears.

# Setting Up your DVD/VCR

## Automatic Channel Setup

You can programme the tuner to scan only the channels that you can receive in your area.

- 1 Turn on the TV and select the video out channel on your TV.
- 2 Press VCR, then DISC/VCR MENU.
- 3 Press ▲/▼ to select TUNER SET UP, then press ►.
- 4 Press ▲/▼ to select AUTO TUNING, then press ►.
  - The tuner scans and memorizes all the active channels in your area. After scanning, the tuner stops on the lowest memorized channel.
- 5 Press P +/- or numerical key pads to scan through channels you have received.

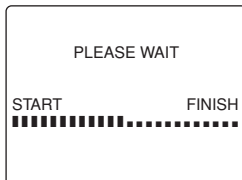

## Manual Channel Preset

- 1 Press VCR, then DISC/VCR MENU.
- 2 Press ▲/▼ to select TUNER SET UP, then press ►.
- 3 Press ▲/▼ to select MANUAL TUNING, then press ►.
- 4 Press ▲/▼ to select PROG., then press ►.
- 5 Press ▲/▼ or numerical key pads to select your desired programme number, then press ►.

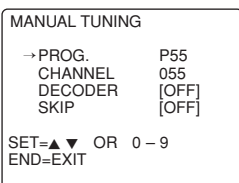

- You can select programme number 01-99.
- 6 Press ▲/▼ to select CHANNEL, then press ►.
  - 7 Press ▲/▼. The DVD/VCR tuner will begin to search up or down automatically. When a channel is found, the DVD/VCR will stop searching and the picture will appear on the TV Screen.
    - You can select desired channel number by using numerical key pads. You must refer to the channel plan and press three digits to select the channel number. (To select channel 24, first press "0" button then press "2" and "4").
    - If this is the channel you want, press ►.
    - If you want to remove scrambled signals, press ▲/▼ to select DECODER. Then, press ► to select [ON].
  - 8 Press STATUS/EXIT to exit.

### Note:

- To confirm that a channel has been added, press the P +/- buttons.
- You should select the satellite channels to be received by the satellite receiver directly on the receiver itself.

## Follow TV (Automatic TV channels sorting)

When the automatic channel search function is activated, the TV channels are saved in a specific order. This may vary from the order of TV channels on the TV.

This function changes the order of TV channels saved in the DVD/VCR to match that of the TV. Make sure that the DVD/VCR and the TV are connected by a scart cable.

- 1 Press VCR, then DISC/VCR MENU.
- 2 Press ▲/▼ to select TUNER SET UP, then press ►.
- 3 Press ▲/▼ to select 'FOLLOW TV', then press ►.
- 4 'P:01' will appear in the DVD/VCR display.

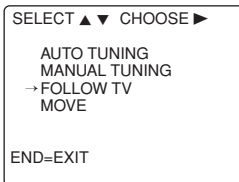

## I cannot switch my TV set to programme number '1'

\* If you have connected additional devices to socket AV2(DECODER), please disconnect these devices. Because of other connected devices, the TV set could switch to the programme number of the scart socket.

## 'NO TV SIGNAL' will appear in the TV screen. The DVD/VCR is not receiving a video signal from the TV.

Check the plug on the scart cable. Check your TV's operating instructions to see which scart socket is used for video signals. If this does not help, it's not possible to use this function. Please read the section 'Sorting TV channels manually'.

- 5 Select programme number '1' on the TV.
- 6 Confirm with ► on the DVD/VCR remote control. The DVD/VCR compares the TV channels on the TV and the DVD/VCR.
  - If the DVD/VCR finds the same TV channel as on the TV, then it stores it at 'P01'.
- 7 Wait until the next number, e.g. 'P:02' appears in the display.
- 8 Select the next programme number on the TV, e.g. '2'.
- 9 Confirm with ►.
- 10 Repeat steps 7 to 9 until you have assigned a programme number to all TV channels.
- 11 To end, press STATUS/EXIT.

## Sorting and clearing TV channels manually

After you have performed the automatic channel search you may not agree with the sequence in which the individual TV channels have been allocated to the programme positions (programme numbers) of the DVD/VCR. You can use this function to individually sort the TV channels already saved or to delete unwanted TV channels or those with poor reception.

## The clock resets automatically

If you save a TV channel that transmits TXT/PDC on programme number 'P01', date and time will constantly be updated. As a result, time changes, i.e. daylight savings time, will be set automatically.

- 1 Press VCR, then DISC/VCR MENU.
- 2 Press ▲/▼ to select 'TUNER SET UP', then press ►.
- 3 Press ▲/▼ to select 'MOVE', then press ►.
- 4 Press ▲/▼ to select the saved TV channel that you want to change.
- 5 Confirm with ►.
- 6 Move the selected channel with ▲/▼ to the programme number you want to assign.
- 7 Confirm with ►.
- 8 To assign other TV channels to a programme number, repeat steps 4 to 7.
- 9 Confirm the assignment of the TV channel with MOVE menu.
- 10 To exit the MOVE menu, press STATUS/EXIT.

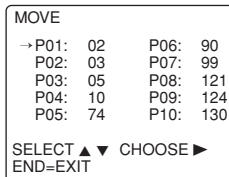

## Setting the language

You have the option of setting one of the displayed languages for the on-screen menu (OSD). However, the DVD/VCR display will only display English text regardless of this setting.

- 1 Press VCR, then DISC/VCR MENU.
- 2 Press ▲/▼ to select 'INITIAL SET UP', then press ►.
- 3 Press ▲/▼ to select 'LANGUAGE', then press ►.
- 4 Select the desired language with ▲/▼.
- 5 To end, press STATUS/EXIT.

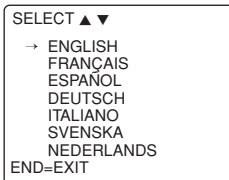



## Setting the clock

If the display shows an incorrect time or '---', the time and date must be reset manually.

If a TV channel that transmits TXT/PDC (teletext/PDC) is stored under programme number 'P01', time/date will automatically be taken from the TXT/PDC information. (SMART CLOCK)

- 1 Press VCR, then DISC/VCR MENU.
- 2 Press ▲/▼ to select 'INITIAL SET UP', then press ►.
- 3 Press ▲/▼ to select 'CLOCK', then press ►.
- 4 Check the time in 'TIME'. If required, please change the time with numerical key pads.
- 5 Check 'DAY', 'MONTH' and 'YEAR' in the same way.
- 6 Choose 'SMART CLOCK' ON or OFF with ►.
- 7 To end, press STATUS/EXIT.

```

TIME  --:--
DATE  --/--
SMART CLOCK [ON]
END=EXIT
    
```

## Setting the RF out channel

In some reception locations it is possible that a TV channel will be sent on the same or similar frequency as the DVD/VCR. Result: As soon as the DVD/VCR is switched on, the reception quality for this or several other TV channels will decrease.

The following steps will show you how to change the pre-set 'transmission' (RF out channel) frequency on the DVD/VCR.

- 1 Press VCR, then DISC/VCR MENU.
- 2 Press ▲/▼ to select 'INITIAL SET UP', then press ►.

### What is RF out channel?

This electronic component in the DVD/VCR allows the device to transmit audio and video signals via the aerial cable. These signals can be received on a TV set just like TV channels.

### What is RF out channel frequency?

This frequency or channel indicates the channel on which the audio or video signal is transmitted.

- 3 Press ▲/▼ to select 'RF OUT', then press ►.
- 4 Press ►.
- 5 Press ▲/▼ or numerical key pads to select a free (not allocated) channel between channel 22 and 69 in your area.
- 6 Press ►.
- 7 To end, press STATUS/EXIT.

```

SELECT ▲▼ CHOOSE ►
→RF OUT CH  36
END=EXIT
    
```

If you cannot get an interference-free picture and sound, switch the built-in modulator off.

Press ▼ repeatedly until "--" appears next to "RF OUT CH" on the TV screen.

Then confirm with ►. In that case, please connect your VCR to your TV with a Scart cable.

## Decoder allocation

Some TV channels transmit encoded TV signals which can only be viewed with a purchased or rented decoder. You can connect such a decoder to this DVD/VCR. The following function will automatically activate the connected decoder for the desired TV channel.

- 1 Switch the TV on. If applicable, select the programme number for the DVD/VCR operation.
- 2 Press ▲/▼ or numerical key pads to select the TV channel which you would like to allocate the decoder to.
- 3 Press DISC/VCR MENU. The main menu will appear.
- 4 Press ▲/▼ to select 'TUNER SET UP'. Then press ►.
- 5 Press ▲/▼ to select 'MANUAL TUNING'. Then press ►.
- 6 Press ▲/▼ to select 'DECODER'.
- 7 Press ► to select 'ON' (Decoder switched on).

```

MANUAL TUNING
PROG.          P55
CHANNEL        055
→DECODER      [OFF]
SKIP           [OFF]
SELECT ▲▼ CHOOSE ►
END=EXIT
    
```

### How can I switch off the decoder?

Use ► to select 'OFF' (Decoder switched off).

- 8 To end, press STATUS/EXIT. The decoder has now been allocated to this TV channel.

## Playing cassettes

You can use this DVD/VCR to play back recorded VHS video-cassettes. You can operate the DVD/VCR using the remote control or the buttons on the front of the DVD/VCR. If you press PLAY, STOP, FWD or REW while the set is in Stand-by, the power will be automatically turned on. Additionally, if a cassette was already inserted, the corresponding operation will be performed.

Your DVD/VCR can only record and play standard VHS cassettes.

- 1 Put a cassette into the cassette slot. The cassette is inserted automatically.
- 2 Press PLAY to view the tape.
- 3 To stop the playback, press STOP or STOP/EJECT on the DVD/VCR.
- 4 To eject the cassette, press EJECT or STOP/EJECT on the DVD/VCR when the DVD/VCR stops the playback.

### DIGITAL STUDIO PICTURE CONTROL

Philips has developed a system which produces the best possible playback quality. For old and often-used video cassettes, this system reduces interference. For new or high quality cassettes, it emphasises the details.

#### Picture/ sound quality is poor

When playing rental videos or older, poorer quality cassettes, it may not be possible to completely filter out picture and sound interference. This is not a fault in your machine. Read the section 'VCR Manual tracking'.

### Do I need to change the playback speed when playing back LP recordings?

During playback, the correct speed will automatically be selected. For more information, please read the section 'Selecting the recording speed (SP or LP)' in the chapter 'VCR Manual recording'.

## Playing back NTSC cassettes

This DVD/VCR can also play back cassettes that have been recorded in SP [Standard Play] or SLP [Super Long Play] mode in the NTSC standard (for example, American cassettes). However, this only works on PAL-television sets that are suitable for a picture frequency of 60Hz.

## Displaying current tape position

The following information is displayed on the screen: e.g.: 0:02:45 shows the counter in hours, minutes and seconds. SP/LP: will show the recorded speed of your cassette 'REM 0:06': will show the actual amount of playing/recording time left on the tape in hours and minutes.

When you play an NTSC cassette, the DVD/VCR will show 'REM :-:-'.

### How can I set the counter to '0:00:00'?

You can set the counter to '0:00:00' with CLEAR. When you put a cassette in the DVD/VCR, the counter will automatically reset to '0:00:00'.

### The counter does not move

This occurs when there are no recordings on a portion of a tape. This is not a fault in your DVD/VCR.

#### The screen shows '-0:01:20'

If you rewind a cassette from the tape position '0:00:00', the counter will show for instance, '-0:01:20' (the cassette was rewound to 1 minute and 20 seconds before '0:00:00'). ('-' (minus) is not shown in the display.)

#### '-:-' is displayed in the 'REM' counter

This counter will automatically recognise the length of the tape. In addition, when you put in a cassette the DVD/VCR must first calculate the time played. Therefore, '-:-' appears first and only after the tape has been running for a few seconds, the correct playing time will be shown.

## Searching for a tape position with picture (scanning)

- 1 While a cassette is playing, press ◀◀ (rewind) or ▶▶ (forward) one or more times.
- 2 Press PLAY ▶ to resume playback.

## Still picture / slow motion

- 1 During playback, press PAUSE ■■ to stop the tape and display a still picture.
  - 2 During playback, press SLOW to play the tape in slow motion.
  - 3 Press PLAY ▶ to resume playback.
- Scanning and still/slow motion interferes with the picture quality. The sound is switched off. This is not a fault in your DVD/VCR.

## Searching for tape position without picture (forward wind and rewind)

- 1 Stop the tape with STOP ■.
- 2 Press ◀◀ (rewind) or ▶▶ (forward).
- 3 To stop the tape, press STOP ■.

## Index search

Every time a tape is recorded an index marking is written on the tape. These marked positions can be found again quickly and easily later.

- 1 To search for the previous marking, press INDEX ▶| and then ◀◀.
- 2 For the next marking, press INDEX ▶| and then ▶▶.
- 3 As soon as the DVD/VCR finds this marking, it automatically switches to playback.

## Manual Tracking

To manually adjust the tracking during playback and slow motion playback, press P+ or P-.

Tracking will return to Automatic Tracking Adjustment when you press STOP ■, insert a tape, or press PLAY ▶.

To remove vertical jitter in a Still picture, press P+ or P-.

## General information

Use 'Manual Recording' to make a spontaneous recording (for example, a programme currently being shown).

If you want to start and stop a recording manually, read the section 'Recording without automatic switch-off'.

If you want to start a recording manually but have it stopped automatically, read the section

Read the section 'Direct record' if you want to record a programme currently being shown.

Read the section 'Automatic controlled recording from a satellite receiver (RECORD LINK)', if you want a recording to be controlled automatically by a satellite receiver.

## Recording without automatic switch-off

- 1 Insert a cassette.
- 2 Use P+/P- to select the programme number you want to record, for example, 'P01'.
- 3 To start recording, press RECORD ●.
- 4 Stop recording with STOP ■.

## Linking up recordings (assemble cut)

When you add a further recording to a cassette, which already has a recording on it, a short blank (flicker) can appear between the old and the new recording or the picture itself can flicker. To help reduce these from occurring, proceed as follows:

- 1 Find the tape position of the old recording where you want to insert the new recording.
- 2 Look at the last minute of the old recording (playback).
- 3 Press PAUSE **||** at the tape position where the new recording is to go and press RECORD **●**.
- 4 Now start recording as usual by pressing RECORD **●** on the remote control.
- 5 Stop recording with STOP **■**.

## Selecting the recording speed (SP or LP)

LP allows to double the recording duration on tape (for example six hours instead of three hours on an E180 cassette).

- 1 Switch on the TV set. If required, select the programme number for the DVD/VCR.
- 2 Press DISC/VCR MENU. The main menu will appear.
- 3 Select 'RECORD SETUP' using **▲/▼** and confirm with **▶**.
- 4 Select 'RECORD SPEED' using **▲/▼**.
- 5 Select the required recording speed with **▶**.

```

SELECT ▲ ▼ CHOOSE ▶
→RECORD SPEED [SP]
DIRECT RECORD [OFF]
RECORD LINK [OFF]

END=EXIT
    
```

### 'SP'/'LP'/'AUTO'

'SP': StandardPlay (normal recording speed) offers the usual first-class picture quality.  
 'LP': LongPlay (half recording speed, double recording time). 6 hours can be recorded on a 3-hour cassette (E180) with a somewhat reduced picture quality.  
 'AUTO': AUTOMATIC Long Play. If there is not enough space on the tape to record a programmed recording in standard speed, the recording is automatically done in 'LP' (Longplay). Otherwise, the recording speed will be 'SP' (Standardplay).

- 6 To end, press STATUS/EXIT.

## Automatic controlled recording from a satellite receiver (RECORD LINK)

This function automatically starts recording on the switched-off DVD/VCR when a video signal is recognised through the connected scart cable. If your satellite receiver has a programming function, the recording will start automatically (as long as the satellite receiver is switched on).

- 1 Use a scart cable to connect scart socket AV2(DECODER) on the DVD/VCR to the corresponding scart socket on the satellite receiver.
- 2 Switch on the TV. If required, select the programme number for the DVD/VCR.
- 3 Press DISC/VCR MENU. The main menu will appear.
- 4 Select 'RECORD SET UP' with **▲/▼** and confirm with **▶**.
- 5 Select 'RECORD LINK' with **▲/▼**.
- 6 Select function 'ON' with **▶**.
- 7 To end, press STATUS/EXIT.
- 8 Insert a cassette.
- 9 Programme the satellite receiver with the required information (programme number of the TV channel, start time, end time).

```

SELECT ▲ ▼ CHOOSE ▶
RECORD SPEED [SP]
DIRECT RECORD [OFF]
→RECORD LINK [OFF]

END=EXIT
    
```

If necessary, please see the operating instructions for your satellite receiver.

- 10 Press TIMER SET.  
 The DVD/VCR is now ready to record. The beginning and end of the recording is controlled via scart socket AV2(DECODER).

## 'Direct Record'

With Direct Record, you can record the right TV channel in seconds even if your DVD/VCR is switched off. If the recording is started manually, the DVD/VCR uses the current TV channel set on the TV. You will find more information on how to switch 'Direct Record' on or off in the next section. Make sure that your DVD/VCR socket (AV1/TV) and the TV are connected by a scart cable.

- 1 On the TV, select the programme number you want make the recording from.
- 2 Press RECORD **●** with the DVD/VCR switched off.
- 3 Stop recording with STOP **■**.

### How does Direct Record work?

The DVD/VCR compares the TV channel selected on the TV set with its stored TV channels via the scart cable. If the same TV channel is found, it switches the DVD/VCR to the corresponding programme number and starts recording. Please do not change the TV channel on the TV set during the search so as not to affect the process.

## Switching 'Direct Record' on or off

- 1 Switch on the TV. If required, select the programme number for the DVD/VCR.
- 2 Press DISC/VCR MENU. The main menu will appear.
- 3 Select 'RECORD SET UP' with **▲/▼** and confirm with **▶**.
- 4 In 'DIRECT RECORD', select 'OFF' (Direct Record off) or 'ON' (Direct Record on) with **▶**.
- 5 To end, press STATUS/EXIT.
- 6 Press STANDBY-ON.

```

SELECT ▲ ▼ CHOOSE ▶
RECORD SPEED [SP]
→DIRECT RECORD [OFF]
RECORD LINK [OFF]

END=EXIT
    
```

## Direct dubbing

Follow the steps below to copy a DVD or video disc to a videotape. This will be possible only if the DVD is not copy protected.

- 1 Put a videotape in the cassette compartment. Make sure the tape's record tab is intact and the tape is long enough to record the disc.
- 2 Press VCR.
- 3 Select the recording speed.  
 Details are at "Selecting the recording speed (SP or LP)".
- 4 Put the DVD you want to copy in the disc tray.
- 5 Press DVD.
- 6 Press PLAY **▶**. While disc is playing, press PAUSE **||** at the point you wish to start recording.
- 7 Press DIRECT DUBBING to record.

### To pause the recording.

Press PAUSE **||**.

### To resume recording.

Press PAUSE **||** again.

### To stop the recording.

Press STOP **■**.

## Recording (From DVD To VCR)

- 1 Insert a DVD without copyright protection in the tray.
- 2 Insert a video cassette tape with its erase prevention tab in place.
- 3 Select the recording speed.  
 Details are at "Selecting the recording speed (SP or LP)".
- 4 Enter "004" with numerical key pads to appear "DISC" on the TV screen.
- 5 Press RECORD **●**.
- 6 Change to DVD operation mode.
- 7 Press DVD, then PLAY **▶** to begin the playback of a DVD.
- 8 Press VCR, then STOP **■** to stop recording.

# Programming a Recording (TIMER)

## General information

Use a TIMER programming to automatically start and stop a recording at a later time or date. The DVD/VCR will switch to the right programme number and begin recording at the correct time. With this DVD/VCR, you can pre-programme up to eight recordings within a period of one year. To make a programmed recording, your DVD/VCR needs to know:

- \* the date you want to make the recording
- \* the programme number of the TV channel
- \* the start and stop time of the recording
- \* VPS or PDC on or off

This information is saved in a TIMER block.

### What is 'VPS/PDC'?

'VPS' (Video Programming System)/ 'PDC' (Programme Delivery Control) are used to control the start and duration of TV channel recordings. If a TV programme starts earlier or ends later than scheduled, the DVD/VCR will turn on and off at the correct time.

### What do I need to know about 'VPS/PDC'?

Usually the VPS or PDC time is the same than the start time. But if your TV guide shows a VPS or PDC time which is different from the programme's scheduled start time, e.g. 20.10 (VPS/PDC 20.14), you must enter the VPS/PDC time exact to the minute. If you want a start time different from the VPS/PDC time, you must switch VPS/PDC off.

## Programming a recording (with the 'SHOWVIEW® system')

# SHOWVIEW®

You no longer need to tediously enter the date, programme number, start and end time. All the information needed for programming is contained in the SHOWVIEW-programming number. You can find this SHOWVIEW number in most TV listing magazines written next to the concerned programme.

- 1 Press SV/V+.
- 2 Enter the entire SHOWVIEW number. This number is up to 9 digits long and can be found next to the start time of the TV programme in your TV listing magazine. [e.g.: 1-234-5 or 1 234 5]  
If you make a mistake, you can clear your input with CLEAR.
- 3 Press SV/V+.
- 4 Select ONCE, DAILY, or WEEKLY recording with ▲/▼. Then press ►.

```
ShowView system
ShowView No.
          12345 ----
SET=SV/V+
CORRECT=CLEAR
END=EXIT
```

```
ShowView system
→ ONCE
  DAILY
  WEEKLY
SELECT ▲ ▼ CHOOSE ►
END=EXIT
```

### Selecting once/daily/weekly recordings

Using ▲/▼, select from the following options:

- 'ONCE': Recording once
- 'DAILY': Repeated daily recordings (Monday to Friday)
- 'WEEKLY': Repeated weekly recordings (every week on the same day)

'-' appears at PROG. .

\* The programme number of the TV channel has not yet been assigned to the SHOWVIEW number. Using the numerical key pads, select the corresponding programme number (name) of the TV channel.

**The following message appears on the screen: 'ERROR'**

\* The entered SHOWVIEW number is incorrect. Correct your input or end with STATUS/EXIT.

\* Check the time/date (see chapter 'Installing your video', section 'Setting the time and date').

\* A daily recording was entered for the wrong day. Daily programming can only be used for recordings to be made from Monday to Friday.

**The following message appears on the screen: 'TIMER NOT COMPLETED'**

\* The channel is wrong.

- 5 The decoded data appears after confirmation. You can go back to change the data. Select the corresponding input field using ► or CLEAR. Change the data with numerical key pad.
- 6 When all inputs are correct, press STATUS/EXIT. The programming information is stored in a Timer block.

### Switching on 'VPS/PDC' in the 'START' input field

Select 'VPS/PDC' using ► or CLEAR. Press '1' to switch off 'VPS/PDC' or press '2' to switch on 'VPS/PDC'.

- 7 Insert a cassette with an intact security tab (unprotected).
- 8 Press TIMER SET.  
'RECORD TIMER' will light up on the DVD/VCR display.

## Programming a recording (without the SHOWVIEW® system)

- 1 Press VCR, then DISC/VCR MENU.
- 2 Select 'TIMER' with ▲/▼. Then press ►.
- 3 Select ONCE, DAILY, or WEEKLY recording with ▲/▼. Then press ►. If all Timer blocks are in use, 'FULL' will appear on the OSD.
- 4 Select the desired Timer block with numerical key pads. (The flashing number indicates an empty TIMER block.)

```
SELECT ▲ ▼ CHOOSE ►
→ ONCE
  DAILY
  WEEKLY
  TIMER LIST
END=EXIT
```

### Selecting once/daily/weekly recordings

Using ▲/▼, select from the following options:

- 'ONCE': Recording once
- 'DAILY': Repeated daily recordings (Monday to Friday)
- 'WEEKLY': Repeated weekly recordings (every week on the same day)

- 5 Enter the Start time (START) End time (STOP), Programme number (PROG.), VPS/PDC information and the Date with numerical key pads.

### Programme numbers of the 'AV1', 'AV2' and 'AV3' scart socket

You can also programme recordings from external sources via scart socket AV1(TV), AV2 (DECODER) or AV3(FRONT).

- 6 When all inputs are correct, press STATUS/EXIT. The programming information is stored in a TIMER block.
- 7 Insert a cassette with an intact security tab (unprotected).
- 8 Press TIMER SET.

## OTR (One Touch Recording)

This function enables you to set a recording length simply by pressing RECORD on the DVD/VCR.

- 1 Follow steps 1 to 2 in "Recording without automatic switch-off" section.
- 2 Press RECORD on the DVD/VCR repeatedly until the desired recording length appears.

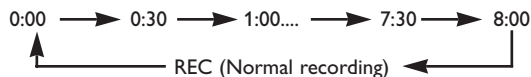

• Recording stops when 0:00 is reached.

**To check time remaining during an OTR**

Press DISPLAY.

**To change the recording length during an OTR**

Press RECORD until the desired length appears.

**To stop an OTR before recording is finished**

Press STOP.

**To cancel the OTR but continue recording**

Press RECORD repeatedly until "REC" appears in the upper left corner of the TV screen.

## How to check, or delete a programmed recording (TIMER)

- 1 Press VCR, then DISC/VCR MENU.
- 2 Press ▲/▼ to select 'TIMER'. Then press ►.
- 3 Press ▲/▼ to select 'TIMER LIST', then press ►.
- 4 Select timer block with ►.
- 5 To cancel the recording, press CLEAR.
- 6 To end, press STATUS/EXIT.
- 7 Press TIMER SET.

SELECT ▲ ▼ CHOOSE ►  
 ONCE  
 DAILY  
 WEEKLY  
 →TIMER LIST  
 END=EXIT

## How to change a programmed recording (TIMER)

- 1 Press VCR, then DISC/VCR MENU.
- 2 Press ▲/▼ to select 'TIMER', then press ►.
- 3 Press ▲/▼ to select ONCE, DAILY, or WEEKLY recording with ▲/▼, then press ►.
- 4 Select a TIMER block with numerical key pads. (The flashing number indicates an empty TIMER block.)
- 5 Press CLEAR to delete information and input correct information with numerical key pads.
- 6 To end, press STATUS/EXIT.
- 7 Press TIMER SET.

ONCE  
 TIMER - 1 2 3 4 5 6 7 8 -  
 SELECT TIMER NUMBER  
 END=EXIT

## Hint for Timer Recording

- If there is a power failure or the DVD/VCR is unplugged for more than 1 minute, the clock setting and all timer settings will be lost.
- If a tape ends during TIMER RECORDING, the DVD/VCR will stop, eject the tape, and switch to the DVD mode automatically as the TIMER light blinks. (If the DVD power is off, the DVD/VCR will become the STANDBY status).
- If a tape is not in the DVD/VCR or does not have a record tab, the TIMER light flashes and timer recording will not operate. Please insert a recordable tape.
- When timer recordings are set, the TIMER light will come on. To use the DVD/VCR as usual until the time for the recording, press TIMER SET so that the TIMER light disappears. Press DVD/VCR to choose VCR or DVD modes, then continue with the other features as described in this manual.

### 'PRESS TIMER SET BUTTON FOR TIMER RECORDING' appears on the screen

\* Press TIMER SET on several minutes before the start of a programmed recording.

#### Error message: 'FULL'

- If this error message appears after you select 'ONCE', 'DAILY', or 'WEEKLY' on TIMER menu and press ►, then all TIMER blocks are already programmed. No more recordings can be programmed. If you want to clear or check a programmed recording (TIMER block), select the programme number on TIMER LIST menu and press CLEAR.

## Switching the status display off or on

Along with the on screen menu, the status display also displays information on the current operating status (counter, playback, recording, TV channel, etc.) on the TV screen. You can switch off the information about the operating status so that the status display is not recorded when copying videocassettes.

- 1 Press VCR, then DISC/VCR MENU.
- 2 Press ▲/▼ to select 'VCR SET UP', then press ►.
- 3 Press ▲/▼ to select 'STATUS DISPLAY', then press ►.
- 4 Press ▲/▼ to select 'ON' or 'OFF', then press ►.
- 5 To end, press STATUS/EXIT.

SELECT ▲ ▼ CHOOSE ►  
 →STATUS DISPLAY [ON]  
 BLUE BACKGROUND [ON]  
 CLOCK DISPLAY [ON]  
 END=EXIT

### Which settings can I choose?

'ON': Shows the status display for a few seconds only.  
 'OFF': Switches off the status display.

## Blue Background on or off

If you want the TV screen to be solid blue when a weak signal is received, set BLUE BACKGROUND to 'ON'. The screen will be blue and the sound will be muted. Or, if you want to receive the weak signal, set BLUE BACKGROUND to 'OFF'.

- 1 Press VCR, then DISC/VCR MENU.
- 2 Press ▲/▼ to select 'VCR SET UP', then press ►.
- 3 Press ▲/▼ to select 'BLUE BACKGROUND', then press ►.
- 4 Select 'OFF' (no blue background) or 'ON' (blue background on) with ►.
- 5 To end, press STATUS/EXIT.

SELECT ▲ ▼ CHOOSE ►  
 STATUS DISPLAY [ON]  
 →BLUE BACKGROUND [ON]  
 CLOCK DISPLAY [ON]  
 END=EXIT

## Clock Display

This function allows you to switch the VCR display off. It is useful in case you feel disturbed by the display-brightness while watching TV in a dark room. It also reduces the power consumption.

- 1 Press VCR, then DISC/VCR MENU.
- 2 Press ▲/▼ to select 'VCR SET UP', then press ►.
- 3 Press ▲/▼ to select 'CLOCK DISPLAY', then press ►.
- 4 Select 'OFF' (no clock display) or 'ON' (clock display on) with ►.
- 5 To end, press STATUS/EXIT.

SELECT ▲ ▼ CHOOSE ►  
 STATUS DISPLAY [ON]  
 BLUE BACKGROUND [ON]  
 →CLOCK DISPLAY [ON]  
 END=EXIT

## Selecting the sound channel

You can select the desired sound channel during playback or while receiving TV channels via the DVD/VCR. This allows you to select a desired language for multi-language transmissions.

- 1 Press AUDIO. This will show the current sound setting.
- 2 Press AUDIO until the desired setting appears in the display.

### • During reception of bilingual broadcasts:

Mode	AUDIO OUTPUT		Display on the TV screen
MAIN	L	Main Audio	MAIN
	R	Main Audio	
SUB	L	Sub Audio	SUB
	R	Sub Audio	
MAIN SUB	L	Main Audio	MAIN SUB
	R	Sub Audio	

### • Reception of stereo broadcasts:

Mode	AUDIO OUTPUT		Display on the TV screen
Stereo	L	L Audio	STEREO
	R	R Audio	
L	L	L Audio	LEFT
	R	L Audio	
R	L	R Audio	RIGHT
	R	R Audio	
Monaural	L	L+R Audio	NONE
	R	L+R Audio	

### • During playback of the recorded tape in Hi-Fi mode:

Mode	AUDIO OUTPUT		Display on the TV screen
Stereo	L	Hi Fi L Audio	STEREO
	R	Hi Fi R Audio	
L	L	Hi Fi L Audio	LEFT
	R	Hi Fi L Audio	
R	L	Hi Fi R Audio	RIGHT
	R	Hi Fi R Audio	
Monaural	L	Normal Audio	MONO
	R	Normal Audio	
MIX	L	Hi Fi L Audio + Normal Audio	MIXED
	R	Hi Fi R Audio + Normal Audio	

## Basic Playback

### Getting Started

Turn on the power of the TV, amplifier and any other components which are connected to the DVD/VCR.

Make sure the TV and audio receiver (commercially available) are set to the correct channel.

- 1 Press STANDBY-ON.
- 2 Press DVD, then OPEN/CLOSE to open disc loading tray.

- 3 Place the chosen disc in the tray, with the label facing up.

- 4 Press PLAY .

- The tray will close automatically, and playback will then start from the first chapter or track of the disc. If the playback does not start automatically, press PLAY .

- When you playback the DVD which a title menu is recorded, it may appear on the screen. In this case, refer to "TITLE MENU".

- 5 Press STOP  to stop playback.

### Notes:



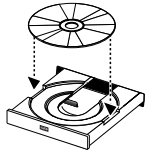

- A "prohibited icon" may appear at the top-right on the TV screen during operation, warning that a prohibited operation has been encountered by the DVD/VCR or the disc. 

- With DVDs that use some titles for playback program signals, playback may start from the second title, or it may skip these titles.

- During the playback of two layered disc, pictures may stop for a moment. This happens when the 1st layer switches to the 2nd layer. This is not a malfunction.





## General Features

DVD or video CDs may contain menus to navigate the disc and access special features. Press the appropriate numerical key pads or use Arrow ( /  /  / ) to highlight your selection in the DVD main menu and press OK to confirm.





### Note:

- Unless stated, all operations described are based on remote control use. Some operations can be carried out using the menu bar on the TV screen.





## Pause

- 1 During playback, press PAUSE .
- Playback will pause and sound will be muted.
- 2 To continue playback, press PLAY .

## Disc Menus

- 1 Press DVD, then DISC/VCR MENU.
  - The DVD main menu will appear.
- 2 If the feature is not available,  symbol may appear on the TV screen.
- 3 If disc menu is available on the disc, audio language, subtitle options, chapters for the title and other options will appear for selection.
- 4 Press Arrow ( /  /  / ) to select an item, and OK to confirm selection.

## Title Menu

- 1 Press DVD, then TITLE.
  - The title menu will appear.
- 2 If the feature is not available,  symbol may appear on the TV screen.
- 3 Press Arrow ( /  /  / ) to select an item, and OK to confirm selection.
  - Playback will begin at the selected Title.

## 

- 1 The title menu will appear.
- 2 Press numerical key pads to select the menu.
  - Playback will start.



## Calling Up a Menu During Playback

- Press DISC/VCR MENU to call up the DVD main menu.
- Press TITLE to call up the title menu.



### Note:

- Contents of menus and corresponding menu operations may vary between discs. Refer to the manual accompanying the disc for details.

## Step by Step Playback

- 1 During playback, press PAUSE .
  - Playback will pause and sound will be muted.
- 2 The disc goes forward by one frame each time PAUSE is pressed.
- 3 To exit step by step playback, press PLAY .



## Resume

- 1 During playback, press STOP .
  - Resume message will appear on the TV screen.
- 2 Press PLAY , playback will resume from the point at which playback was stopped.
  - To cancel resume, press STOP  twice.







### Note:

- If you turn the DVD/VCR off, Resume function will be cancelled.
- Some Video CDs with PBC function resume playback from the beginning of the track.

## Fast Forward / Reverse Search

- 1 During playback, press FWD  or REV  repeatedly to select the required forward or reverse speed: x2, x8, x50, x100.
  - For video CDs, the speed is fixed at x2, x8, x30.
  - For audio CDs, the speed is fixed at x16.
  - For MP3, the speed is fixed at x8.
- 2 To return to normal playback, press PLAY .

## Slow Forward / Slow Reverse

- 1 During playback, press PAUSE .
- 2 Press  or .
  - Slow motion playback will begin and sound will be muted.
- 3 Press  or  repeatedly to select the required speed: 1/16, 1/8, 1/2 of the normal playback.
- 4 To return to normal playback, press PLAY .

### Note:

- Slow Reverse is not available on video CDs.

## Zoom DVD-V VCD

Zoom function allows you to enlarge the video image and to pan through the enlarged image.

- 1 Press **ZOOM** during playback.
  - Playback will continue.
- 2 Press **ZOOM** repeatedly to select the required zoom factor: x2, x4 or OFF.
- 3 Use Arrow ( **▼** / **▲** / **▶** / **◀** ) to move the zoomed picture across the screen.
- 4 To exit zoom mode, press **ZOOM** to OFF.

**Notes:**

- **Zooming function does not work while disc menu is shown.**
- **x4 zoom is not available on some discs.**
- **only x2 zoom is available on video CDs.**

## Track CD VCD (without PBC function)

There are three ways to begin playback on an Audio CD at a specific Track.

### Using the Numerical key pads

- 1 Press **numerical key pads** to enter the desired Track number.
  - Playback will start at the selected track.
  - For single digit tracks (1-9), press a single number (eg. track 3, press 3).
  - To play track 26, press +10, 2, 6 on the numerical button.

### Using the SEARCH MODE

- 1 Press **SEARCH MODE**.
  - The track search display appears.
- 2 Within 30 seconds, select a desired track number using **numerical key pads**. For single digits press "0" first.
  - Playback will start at the selected track.

### Using the SKIP **⏮** **⏭**

During playback, press **SKIP** **⏭** to move to the next track. Press it repeatedly to skip subsequent tracks. Press **SKIP** **⏮** to go back to the beginning of the current track. Press it repeatedly to go to the previous tracks.

- Track number will appear briefly on the DVD display panel.
- If **SKIP** is pressed while the playback is paused, the playback will be paused again after skipping to the next track.

**Note:**

- **SKIP** **⏮** **⏭** are not available when playback is stopped.

## Title / Chapter Search DVD-V

- 1 Press **SEARCH MODE** once for the Chapter search, twice for the Title search during playback.
- 2 Enter the desired chapter/title number using **numerical key pads**.

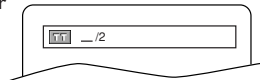

## Time Search DVD-V CD VCD (without PBC function)

- 1 During playback, press **SEARCH MODE** three times (CD/VCD: twice) to display the Time Search on the TV screen.
- 2 Within 30 seconds, enter a desired disc time using **numerical key pads**.
  - Playback will start at the specified time.
- 3 Press **CLEAR** to erase the incorrect input.

## Repeat

- **REPEAT** are available only during playback.

### Repeat Title / Chapter DVD-V

To activate the repeat function, press **REPEAT** during playback. The repeat mode changes as described below every time you press the button.

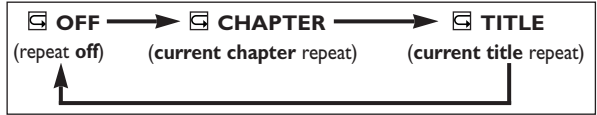

**Notes:**

- **Repeat Title/Chapter is not available with some scenes.**
- **The REPEAT setting will be cleared when moving to other title or chapter.**

### Repeat Track CD VCD (without PBC function)

To activate the repeat function, press **REPEAT** during playback. The repeat mode changes as described below every time you press the button.



**MP3**

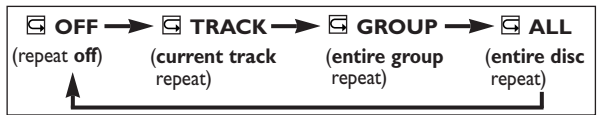

**Notes:**

- **The REPEAT setting will be cleared when moving to other track.**
- **Repeat playback does not function during repeat A-B playback.**
- **Repeat playback is not available when you play the Video CD with PBC function.**

### Repeat at A-B CD VCD

- 1 Press **REPEAT A-B** at your chosen starting point.
  - **A-** appears briefly on the TV screen.
- 2 Press **REPEAT A-B** again at your chosen end point.
  - **A-B** appears briefly on the TV screen, and the repeat sequence begins.
- 3 To exit the sequence, press **REPEAT A-B**.

**Notes:**

- **The repeat A-B section can only be set within the current title (for DVDs), or current track (for audio CDs).**
- **Repeat A-B is not available with some scenes in DVD.**
- **To cancel the A point which was set, press CLEAR.**
- **Repeat A-B playback does not function during title, chapter, track or all repeat playback.**

# Playing a Disc



## Program

You may determine the order in which tracks will play.

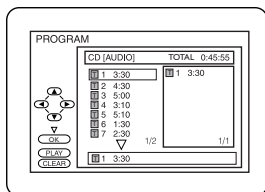
- 1 In stop mode press MODE.
  - The PROGRAM screen will appear.
- 2 Press ▲ or ▼ to select a track, then press OK.
  - Press CLEAR to erase the The most recently entered program.
- 3 Press PLAY ► to play the programmed tracks.



### Notes:

- While the program is being played back, the STOP ■ works as follows.
- Press STOP ■ once and then PLAY ► again, playback will restart from the point where STOP ■ was pressed. (Program continued)
- Press STOP ■ twice and then PLAY ► again, playback will restart from the track in the usual way. (Program cleared)
- Up to 99 programs can be entered.
- If you like to repeat the current track in the program, press REPEAT repeatedly until  TRACK appears during playback. If you like to repeat the entire program press REPEAT repeatedly until  ALL appears during playback.



## Random Playback

This shuffles the playing order of tracks instead of playback in the sequence.

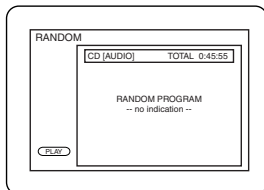
- 1 In stop mode, press MODE twice.
  - RANDOM screen appears.
- 2 Press PLAY ► to start random playback.



### Notes:

- If you like to repeat the current track in the random selection, press REPEAT repeatedly until  TRACK appears during playback. If you like to repeat the entire random selection press REPEAT repeatedly until  ALL appears during playback.



## MP3/JPEG Playback

When a CD with MP3 or JPEG files is inserted in the DVD/VCR, the MP3 or JPEG menu will appear on the TV screen, and number of tracks is displayed on the front panel.

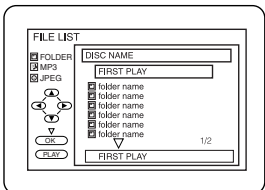
- 1 In stop mode, press ▲ or ▼ to select the desired group, MP3 track or JPEG file.
  - If a group is selected, press PLAY ► or OK to go on to the track selection screen. Press ▲ or ▼ to choose a track, then press PLAY ► or OK.
  - If a track is selected, press PLAY ► or OK to start playing tracks. Starting from the one you've just chosen the subsequent tracks will be played.
  - Choose FIRST PLAY to start playback from the beginning of the listed tracks.
  - Press TITLE to return to the first item.
- 2 Press STOP ■ to stop playback.



### Notes:



- Folders are known as Groups; files are known as Tracks.
- MP3 files are accompanied by  icon.
- JPEG files are accompanied by  icon.
- Maximum of 255 folders can be recognized.
- Maximum of 256 files can be recognized.
- Up to 8 hierarchies can be created.

This player recommends the use of files recorded at the below specifications:

- Sampling frequency: 44.1kHz or 48kHz
- Constant bit rate: 112kbps ~ 320kbps.

## On-Screen Information

You can check the MP3 files during playback.

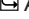
- 1 Press DISPLAY.
  - The name of the file currently in play will be displayed.
- 2 Press DISPLAY again to show the track number, the elapsed time, the repeat status, and the playback status at the top of the screen.
  -  will be displayed when the repeat play has been selected.
  -  T - indicates Track repeat
  -  G - indicates Group (folder) repeat
  -  A - indicates Disc repeat
- 3 Press DISPLAY again to exit.

## Track Selection

- 1 Press SEARCH MODE during playback.
  - The FILE LIST will appear.
- 2 Select a desired track using Arrow (▼/▲/►/◄).
  - Press ► when you want to go to the next hierarchy.
  - Press ◄ when you want to go back to the previous hierarchy.
- 3 Press PLAY ► to start playing.  
**Notes:**
  - Press SEARCH MODE to EXIT.
  - Some selections may take a while to be recognized.

## Random Playback

- 1 Press MODE twice while playback is stopped.
- 2 Press PLAY ► to play the tracks in random order.

## Program

This feature allows you to program a mp3 disc to play in a desired sequence.

- 1 Press MODE during playback is stopped.
  - The PROGRAM screen will appear.
- 2 Press ▲ or ▼ to select a track, then press OK, to save it in a program.
  - Press CLEAR to erase the incorrect input.
- 3 Press PLAY ► to start programmed playback.

## Audio Language

The DVD/VCR allows you to select a language during DVD disc (if multi language available) playback.

- 1 Press AUDIO during playback.
- 2 Press AUDIO repeatedly to select your desired language.

### Notes:

- Pressing AUDIO may not work on some DVDs with multiple audio languages (e.g. DVDs which allow audio language setting on the disc menu).
- Some discs allow audio language setting on the disc menu. (Operation varies between discs, so refer to the manual accompanying the disc.)

## Stereo Sound Mode

- 1 Press AUDIO repeatedly during playback to select between STEREO, L-CH or R-CH.
  - STEREO - both right and left channels are active (stereo)
  - L-CH - only left channel is active
  - R-CH - only right channel is active

### Note:

- If the Virtual Surround setting is ON, the sound mode will be fixed to STEREO, and can not be changed.



## Subtitle Language DVD-V

The DVD/VCR allows you to select a language for subtitle during DVD disc (if available) playback.

- 1 Press DVD, then SUBTITLE during playback.
- 2 Press SUBTITLE repeatedly to select your desired subtitle language.
  - The selected language will be displayed on the display bar at the top of the screen.
- 3 To turn off subtitles, press SUBTITLE repeatedly until OFF appears.

### Notes:

- Some discs allow subtitle language setting on the disc menu. (Operation varies between discs, so refer to the manual accompanying the disc.)
- If the desired language is not shown after pressing SUBTITLE several times, the disc does not have subtitles in that language.
- If you choose a Language that has a 3 letter language code, the code will be displayed every time you change the Subtitle language setting. If you choose any other languages, '---' will be displayed instead. (Refer to back inside-cover.)

## Camera Angle DVD-V

Some DVD discs contain scenes which have been shot simultaneously from various angles. You can change the camera angle when the  icon appears on the screen.

- 1 Press DVD, then ANGLE during playback.
  - The selected angle will be displayed on the display bar at the top of the screen.
- 2 Press ANGLE repeatedly to select your desired angle.

## Changing the On-Screen Display DVD-V

You can check information about the current disc by pressing DISPLAY on the remote control.

- 1 Press DISPLAY during playback to show current Chapter.
  - ➔ The elapsed and remaining playing time of the current chapter will be displayed.
- 2 Press DISPLAY again to show current Title.
  - ➔ The elapsed and remaining playing time of the current title will be displayed.
- 3 Press DISPLAY the third time.
  - ➔ The BIT RATE, layer number (if available) and the current repeat setting will be displayed.
- 4 Press DISPLAY the fourth time to remove the display.

CD VCD (without PBC function)







- 1 Press DISPLAY during playback, the current Track will be displayed on the TV screen.
  - ➔ The elapsed and remaining playing time of the current total track will be displayed.
- 2 Press DISPLAY again to show current Total Track.
  - ➔ The elapsed and remaining playing time of the current total track will be displayed.
- 3 Press DISPLAY the third time to remove the display.

## Parental Control DVD-V

Parental Control limits the disc viewing that exceed your settings. (with a password or playback will stop.) This feature allows you to prevent discs with alternative scenes from being played by your children.



### Parental Level

Parental Level allows you to set the rating level of your DVD discs. Playback will stop if the disc's ratings exceed the level you set.

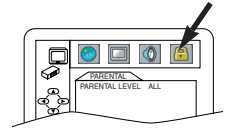
- 1 Press SYSTEM MENU in STOP mode.
- 2 Press  to select CUSTOM, then press OK.
- 3 Press  or  to select PARENTAL, then press OK.
- 4 Enter your four-digit password then press OK.
- 5 Press  or  to select PARENTAL LEVEL, then press OK.
- 6 Press  or  to select the desired level, then press OK.
- 7 Press SYSTEM MENU to exit.



### Notes:

- When doing this for the first time, enter any 4 digits. (except for 4737) That number will be used as the password from the second time onward.
- To change the password, press  or  to select CHANGE, then press OK. Enter the four-digit password, then press OK.
- With some DVDs, it may be difficult to find if they are compatible with parental lock. Be sure to check if the parental lock function operates in the way that you have set.
- Record the password in case you forget it.

### If You Forget the Password

- 1 Press 4, 7, 3, 7 at step 4.
  - Password will be cleared and parental level will be set to ALL.
- 2 Proceed the above steps 4-5 again.

### Control Levels

#### ALL

All parental lock is cancelled.

#### Level 8

DVD software of any grade (adult/general/children) can be played back.

#### Levels 7 to 2

Only DVD software intended for general use and children can be played back.





#### Level 1

Only DVD software intended for children can be played back, with those intended for adult and general use prohibited.

## Marker Setup Screen DVD-V CD VCD (without PBC function)





Use markers to memorise your favourite places on a disc.

- 1 Press SEARCH MODE four times (CD: three times) during playback.
  - The display screen and Markers will appear on the TV screen.
- 2 Press  or  to select 1, 2, 3, 4, 5, 6, 7, 8, 9, or 10 and ensure that "-- :--" appears in the display.
- 3 When reaches the desired point, press OK.
  - The Title or Track and elapsed playing time will appear in the TV screen.
- 4 To return to the Marker later, press SEARCH MODE four times (CD/VCD: three times) during playback and  or  to choose the desired marker, then press OK.



### Notes:

- Opening the disc tray or turning off the power or select AC at step 2 and press OK will erase all Markers.
- To clear a marker, using  or , position the cursor on to the marker number to be cleared and press CLEAR.
- You can mark up to 10 points.

- 5 Press SEARCH MODE or RETURN to exit.

## Audio Setting

Choose the appropriate Audio settings for your equipment as it only affect during the playback of DVD discs of the DVD/VCR.

- 1 Press SYSTEM MENU in STOP mode.
- 2 Press **▶** to select CUSTOM, then press OK. CUSTOM mode will appear.
- 3 Press **◀** or **▶** to select AUDIO, then OK to confirm.
- 4 Press **▲** or **▼** to select the below items, then press OK.

### DRC (Dynamic Range Control) :

To compress the range of sound volume. The default setting is OFF.

### Dolby Digital : QUICK

Set to ON when the player is connected to Dolby Digital Decoder. (ON : Output by Dolby Digital) (OFF : Convert the Dolby Digital to PCM) The default setting is ON.

### DOWN SAMPLING :

Set to ON when outputting in 48kHz. The default setting is ON.

### When playing disc with copyright Protection

- If you select OFF, copyright protection will be activated and sound will be down sampled at 48kHz.

### MPEG :

Set to ON when the player is connected MPEG Decoder. (ON: Output by MPEG) (OFF: Convert the MPEG to PCM) • The default setting is OFF.

- 5 Press SYSTEM MENU to exit.

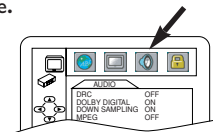

- 5 Press **▲** or **▼** to select a setting, then press OK.
  - If OTHER is selected in the AUDIO, SUBTITLE or DISC MENU screen, press four-digit number to enter the code for the desired language. (Refer to the language code list on back inside cover).
  - Only the languages supported by the disc can be selected.
- 6 Press SYSTEM MENU to exit.

### Note:

- Language Setting for Audio and Subtitle is not available with some discs. Then use AUDIO and SUBTITLE. Details are on pages 16-17.

## Display Setting DVD-V

**E** markers to memorise your favourite places on a disc. Press SYSTEM MENU in STOP mode.

- 2 Press **▶** to select CUSTOM, then press OK.
  - CUSTOM mode will appear.
- 3 Press **◀** or **▶** to select DISPLAY, then OK to confirm.
- 4 Press **▲** or **▼** to select the below items, then press OK.

### TV Aspect : QUICK

Press **▲** or **▼** for an item selection, then press OK.

Select 4:3 LETTER BOX for a black bars appears on top and bottom of the screen.

Select 4:3 PAN & SCAN for a full height picture with both sides trimmed.

Select 16:9 WIDE if a wide-screen TV is connected to the DVD/VCR.

The default setting is 4:3 LETTER BOX.

### Angle Icon :

Press OK repeatedly to turn Angle icon ON or OFF. The default setting is ON.

### Auto Power Off :

Press OK repeatedly to turn Auto Power off ON or OFF. The default setting is ON and it will turn the DVD/VCR to off automatically after 35 minutes of no use.

- 5 Press SYSTEM MENU to exit.

### Notes:

- Be sure to press SYSTEM MENU, or the setting will not work.

- You can also choose the item by pressing the numbers.

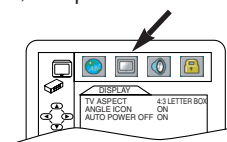

## Virtual Surround DVD-V CD MP3 VCD

You can enjoy stereophonic visual space on your existing stereo system.

- 1 Press MODE during playback.
- 2 Press OK to set it 1(Natural effect), 2(Emphasized effect) or OFF.
- 3 Press MODE or RETURN to exit.

### Note (for CD play only):

- Virtual Surround will not be effective if the sound mode is set to something other than STEREO.



## Language Setting DVD-V

**E** language options are not available with some discs. Press SYSTEM MENU in STOP mode.

- 2 Press **▶** to select CUSTOM, then press OK.
  - CUSTOM mode will appear.
- 3 Press **◀** or **▶** to select LANGUAGE, then OK to confirm.
- 4 Press **▲** or **▼** to select the below items, then press OK.

### AUDIO :

Sets the audio language.

### SUBTITLE :

Sets the subtitle language.

### DISC MENU :

Sets the language for DVD Menu.

### PLAYER MENU : QUICK

Sets the language for the On-Screen display.

## Maintenance

### Cleaning the Cabinet

- Use a soft cloth slightly moistened with a mild detergent solution. Do not use a solution containing alcohol, spirits, ammonia or abrasives.

### Cleaning Discs

- When a disc becomes dirty, clean it with a cleaning cloth. Wipe the disc from the centre out. Do not wipe in a circular motion.
- Do not use solvents such as benzine, thinner, commercially available cleaners, or antistatic spray intended for analogue records.

### Cleaning the disc lens

- After prolonged use, dirt or dust may accumulate at the disc lens. To ensure good playback quality, clean the disc lens with Philips CD Lens Cleaner or any commercially available cleaner. Follow the instructions supplied with the cleaner.

## PLAYBACK SYSTEM

DVD Video, Audio CD, DVD+RW, DVD-R/RW, DVD+R, CD-R/RW, VIDEO CD

DVD	fs 96 kHz	20 Hz - 44 kHz
	fs 48 kHz	20 Hz - 22 kHz
CD	fs 44.1 kHz	20 Hz - 20 kHz
Signal-Noise (1kHz)		70 dB
Dynamic Range (1kHz)		70 dB
Distortion and Noise (1kHz)		0.1%

## TV STANDARD (PAL/50Hz) (NTSC/60Hz)

Number of lines	625	525
Playback	Multistandard	(PAL/NTSC)

## VIDEO PERFORMANCE

Video output	1 Vpp into 75 ohm
RGB (SCART) output	0.7 Vpp into 75 ohm
Video Shift	Left/Right

## VIDEO CASSETTE RECORDER

Video heads	Four heads Hi-Fi
Antenna	VHF/UHF - 75 ohm
VHF output	75 ohm unbalanced

## AUDIO FORMAT

Digital	MPEG	Compressed Digital
	Dolby Digital	16, 20, 24 bits
	PCM	fs, 44.1, 48, 96 kHz

Analogue Stereo Sound  
Dolby Surround-compatible downmix from Dolby Digital multi-channel sound  
3D Sound for virtual 5.1 channel sound on 2 speakers

## AUDIO PERFORMANCE

DA Converter 24 bits

## CONNECTIONS

SCART	2x Euroconnector
S-Video Output	Mini DIN, 4 pins
Audio L+R output	2x Cinch (white/red)
Digital Output	1 coaxial, 1 optical

## CABINET

Dimensions (w x h x d)	435 x 99 x 218 mm
Weight	Approximately 3.8 Kg

## POWER SUPPLY (UNIVERSAL)

Power inlet	220 ~ 240 V , 50 Hz
Power usage	Approx. 30 W
Power usage standby	9.2 W (standby : 5.0 W) (When CLOCK DISPLAY set to OFF)

*Specifications subject to change without prior notice*

# Troubleshooting

Problem	Solution
<b>No power</b>	- Check if the AC power cord is properly connected.
<b>No picture</b>	- Check if the TV is switched on. - Check the video connection.
<b>Distorted picture</b>	- Sometimes a small amount of picture distortion may appear. This is not a malfunction.
<b>Completely distorted picture or black/white picture with DVD</b>	- Connect DVD/VCR directly to the TV. - Make sure the disc is compatible with the DVD/VCR.
<b>No sound or distorted sound</b>	- Adjust the volume. - Check that the speakers are connected correctly.
<b>No audio at digital output</b>	- Check the digital connections. - Check if the audio format of the selected audio language matches your receiver capabilities.
<b>No DTS audio at analog output</b>	- Use a DIGITAL AUDIO OUT jack when outputting the DTS audio.
<b>No sound and picture</b>	- Check that the SCART cable is connected to the correct device (See Connecting to a TV)
<b>Picture freezes momentarily during playback</b>	- Check the disc for fingerprints/scratches and clean with a soft cloth wiping from centre edge. - This may happen when you use the disc recorded in the non-seamless manner. This is not a malfunction.
<b>Disc can't be played</b>	- Ensure the disc label is facing up. - Check if the disc is defective by trying another disc.
<b>No return to start-up screen when disc is removed</b>	- Reset the unit by switching the DVD/VCR off, then on again.
<b>The DVD/VCR does not respond to the remote control</b>	- Aim the remote control directly at the sensor on the front of the DVD/VCR. - Reduce the distance to the DVD/VCR. - Replace the batteries in the remote control. - Re-insert the batteries with their polarities (+/- signs) as indicated.
<b>Buttons do not work or DVD/VCR stops responding</b>	- To completely reset the DVD/VCR, unplug the AC cord from the AC outlet for 5-10 seconds.
<b>DVD/VCR does not respond to some operating commands during playback.</b>	- Operations may not be permitted by the disc. Refer to the instructions of the disc.
<b>DVD/VCR cannot read CDs/DVDs</b>	- Use a commonly available cleaning CD/DVD to clean the lens before sending the DVD/VCR for repair.
<b>The DVD/VCR switches from DVD mode to VCR mode after 35 minutes</b>	- Playback will stop for more than 35 minutes and no button is pressed.
<b>The VCR do not record a TV program</b>	- Make sure the tape has a record tab. - Make sure the DVD/VCR is in VCR position. - Check the TV and the DVD/VCR channel are similar.
<b>The DVD/VCR do not perform a timer</b>	- Make sure the recording start and stop times are set correctly. - Make sure the tape has a record tab. - Make sure the clock is set. - The DVD/VCR may not perform or continue a timer recording if the power fails for more than 1 minute.
<b>The motor (cylinder) rotates even when tape playback is stopped</b>	- To enable quick play mechanism, the cylinder will rotate for about five minutes. This is normal.
<b>You cannot insert a tape</b>	- Insert a tape, window side up with the record tab facing you. - Gently push on the center of the tape when putting into the DVD/VCR.
<b>You cannot remove a tape</b>	- Make sure the power plug is completely connected to a power outlet.
<b>DVD/VCR ejects the tape when you press RECORD or TIMER SET for a timer recording.</b>	- Make sure the tape has a record tab.

*If you are unable to remedy a problem by following these hints, consult your dealer or service centre (HOTLINE).*

<u>Language</u>	<u>Code</u>	<u>Language</u>	<u>Code</u>	<u>Language</u>	<u>Code</u>	<u>Language</u>	<u>Code</u>
<b>A-B</b>		French [FRE]	5264	Macedonian	5957	Siswat	6565
Abkhazian	4748	Frisian	5271	Malagasy	5953	Slovak	6557
Afar	4747	Galician	5358	Malay	5965	Slovenian	6558
Afrikaans	4752	Georgian	5747	Malayalam	5958	Somali	6561
Albanian	6563	German [GER]	5051	Maltese	5966	Spanish [SPA]	5165
Amharic	4759	Greek [GRE]	5158	Maori	5955	Sundanese	6567
Arabic	4764	Greenlandic	5758	Marathi	5964	Swahili	6569
Armenian	5471	Guarani	5360	Moldavian	5961	Swedish [SWE]	6568
Assamese	4765	Gujarati	5367	Mongolian	5960	<b>T</b>	
Aymara	4771	Hausa	5447	Nauru	6047	Tagalog	6658
Azerbaijani	4772	Hebrew	5569	Nepali	6051	Tajik	6653
Bashkir	4847	Hindi	5455	Norwegian [NOR]	6061	Tamil	6647
Basque	5167	Hungarian [HUN]	5467	<b>O-R</b>		Tatar	6666
Bengali;Bangla	4860	<b>I-K</b>		Occitan	6149	Telugu	6651
Bhutani	5072	Icelandic [ICE]	5565	Oriya	6164	Thai	6654
Bihari	4854	Indonesian	5560	Oromo(Afan)	6159	Tibetan	4861
Bislama	4855	Interlingua	5547	Panjabi	6247	Tigrinya	6655
Breton	4864	Interlingue	5551	Pashto;Pushto	6265	Tonga	6661
Bulgarian	4853	Inupiak	5557	Persian	5247	Tsonga	6665
Burmese	5971	Irish [IRI]	5347	Polish	6258	Turkish [TUR]	6664
Byelorussian	4851	Italian [ITA]	5566	Portuguese [POR]	6266	Turkmen	6657
<b>C-E</b>		Japanese [JPN]	5647	Quechua	6367	Twi	6669
Cambodian	5759	Javanese	5669	Rhaeto-Romance	6459	<b>U-Z</b>	
Catalan	4947	Kannada	5760	Romanian [RUM]	6461	Ukrainian	6757
Chinese [CHI]	7254	Kashmiri	5765	Russian [RUS]	6467	Urdu	6764
Corsican	4961	Kazakh	5757	<b>S</b>		Uzbek	6772
Croatian	5464	Kinyarwanda	6469	Samoa	6559	Vietnamese	6855
Czech	4965	Kirghiz	5771	Sangho	6553	Volapuk	6861
Danish [DAN]	5047	Kirundi	6460	Sanskrit	6547	Welsh	4971
Dutch [DUT]	6058	Korean [KOR]	5761	Scots Gaelic	5350	Wolof	6961
English [ENG]	5160	Kurdish	5767	Serbian	6564	Xhosa	7054
Esperanto	5161	<b>L-N</b>		Serbo-Croatian	6554	Yiddish	5655
Estonian	5166	Laothian	5861	Sesotho	6566	Yoruba	7161
<b>F-H</b>		Latin	5847	Setswana	6660	Zulu	7267
Faroese	5261	Latvian;Lettish	5868	Shona	6560		
Fiji	5256	Lingala	5860	Sindhi	6550		
Finnish [FIN]	5255	Lithuanian	5866	Singhalese	6555		

**PHILIPS NORGE AS**

Sandstuveien 70,  
PO Box 1, Manglerud  
N-0612 Oslo  
NORWAY  
Phone: 2274 8250

**OY PHILIPS AB**

Sinikalliontie 3,  
02630 Espo  
Helsinki  
FINLAND  
puh. 09 615 80 250

**PHILIPS KUNDTJÄNST**

Kollbygatan 7,  
Akalla,  
16485 Stockholm  
SWEDEN  
Phone: 08-598 52 250

**PHILIPS POLSKA**

AL. Jerozolimskie 195B  
02-222 Warszawa  
POLSKA  
Tel.: (022)-571-0-571

**PHILIPS SERVICE**

V Mezihori 2  
180 00 Prague  
CZECH REPUBLIC  
Phone: (02)-3309 9240

**PHILIPS Iberia, S.A.**

C/Martinez Villergas, 49  
28027 MADRID  
SPAIN  
Phone: 902-11 33 84

**ΦΙΛΙΠΣ ΕΛΛΑΣ ΑΕΒΕ**

25ΗΣ ΜΑΡΤΙΟΥ 15  
177 78 ΤΑΥΡΟΣ  
ΑΘΗΝΑ  
Τηλ. 00800 3122 1280

**PHILIPS**

Österreichische Philips Industrie  
GmbH  
Triesterstrasse 64  
1101 Wien  
AUSTRIA  
Tel: 0810 001 203

**PHILIPS INFO CENTER**

Alexanderstrasse 1  
20099 Hamburg  
GERMANY  
Tel: 0180-53 56 767

**SERVICE CONSOMMATEURS**

**PHILIPS**  
BP 0101  
75622 Paris Cédex 13  
FRANCE  
Phone: 0825-889 789

**PHILIPS ELECTRONICS  
IRELAND LIMITED**

Consumer Information Center  
Newstead, Clonskeagh  
DUBLIN 14  
Phone: 01-7640292

**PHILIPS CONSUMER  
ELECTRONICS**

Servizio Consumatori  
Via Casati 23  
20052 Monza - Milano  
ITALY  
Phone: 800 820026

**PHILIPS MÁRKASZERVIZ**

Kinizsi U 30 - 36  
Budapest 1092  
HUNGARY  
Phone: (01)-2164428

**PHILIPS PORTUGUESA, S.A.**

Consumer Information Center  
Rua Dr. António Loureiro Borge, nr.5  
Arquiparque, Miraflores  
P-2795 L-A-VEHLA  
PORTUGAL  
Phone: 021-4163063

**PHILIPS CE, The Philips Centre,**

420 - 430 London Road,  
Croydon, Surrey  
CR9 3QR  
UNITED KINGDOM  
Phone: 0208-665-6350

**CONSUMER SERVICES**

Prags Boulevard 80. PO Box 1919,  
DK-2300 Copenhagen S  
DANMARK  
Tlf: 32 88 32 00

**PHILIPS REPRESENTATION  
OFFICE**

Ul. Usacheva 35a  
119048 MOSCOW  
RUSSIA  
Phone: 095-937 9300

**PHILIPS INFO CENTER**

Fegistrasse 5  
8957 Spreitenbach  
SUISSE  
Tel.: 0844-800 544

**PHILIPS CUSTOMER CARE  
CENTER**

Twee Stationsstraat 80/  
80 Rue des Deux Gares  
1070 BURSSEL/BRUXELLES  
BELGIUM (for BENELUX)  
Tel: 070-222303

Meet Philips at the Internet

<http://www.philips.com>



The products and services described herein are not necessarily available in all countries  
Due to continuous product improvements this document is subject to change without notice.